

SMSC1506- Installation

A. What is included in the box

1. Shower Corner Caddy

B. Installation Preparation

1. Nail
2. Silicone Sealant
3. Packaging Tape

C. Installation

1. Clean the surface where the caddy will be installed and wipe off any water/residues to dry completely. Drive the nail until $\frac{2}{5}$ " is left so that the shower corner caddy can be hung on the nail.

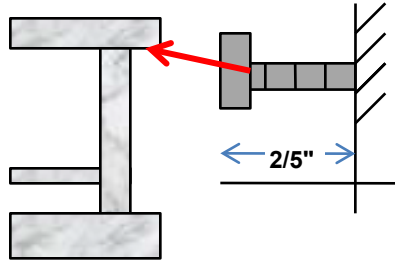

2. Apply enough silicone sealant to the back of the shower corner caddy.
3. After hooking the shower corner caddy to the nail, apply lateral force to fit the caddy into the corner wall.
4. Complete the installation by caulking around all edges of the shower corner caddy.
5. Use packaging tapes to secure and reinforce as shown in the picture below.
6. Allow 3 days for the silicone sealant to be completely dried. When silicone sealant is dried, remove the packaging tapes.

