

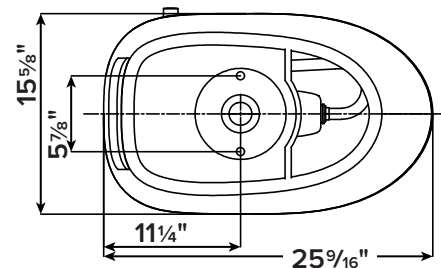

FEATURES

- Siphonic jet high efficiency dual flushing system (1.28GPF/4.85LPF and 0.87GPF/3.29LPF)
- Multifunction wireless remote control
- Anti-seize glaze toilet bowl and automatic pre-wetting of inner bowl minimize debris and mold from sticking to the surface
- Seat temp adjustment at 4 levels (room temperature, 91.4°F, 96.8°F, 102.2°F)
- Water pressure adjustment (4 levels)
- Water temp adjustment at 4 levels (room tempature, 91.4°F, 96.8°F, 102.2°F)
- 6 wash options: rear, rear oscillating, front, front oscillating, child, and lady
- Self-cleaning and antibiosis nozzle with 5 levels of adjustable spray position
- Warm air drying position at 5 different levels
- Warm air drying temp adjustment at 4 levels (95°F, 107.6°F, 118.4°F, 129.2°F)
- Auto deodorization, Auto flush
- Seat sensor (functions activated by sitting on the seat)
- Foot sensor (flush)
- Rotational side knob control (backup manual front/back wash/drying and flush)
- Soothing light surrounding side knob
- Night light
- UV air purifier: uses UV-C light to inactivate pathogens and microorganisms in the air
- UV sterilization
- Tankless instant water heating
- Water purifier with filter
- Damper in seat and cover allow them to close softly
- 4.92 ft. power cord
- Backup power available
- Nano silver ions antibacterial protection
- Ceramic bidet toilet body, polypropylene seat/lid, and stainless steel nozzle
- 5-Year Limited Residential Warranty / 1-Year Commercial Warranty

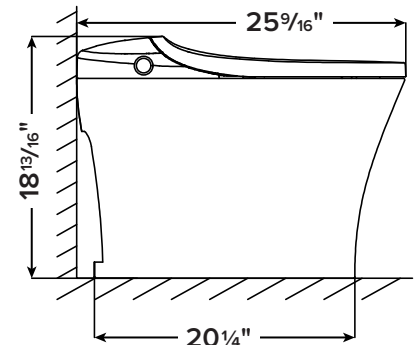
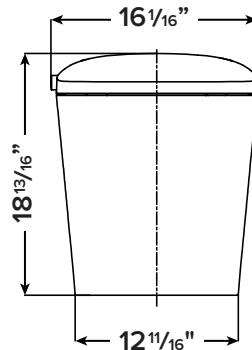

Smart Bidet Models

	Model No.	Description	Length	Width	Height	Ship Wt. (lbs)
COMPLETE SMART BIDET TOILET						
<input type="checkbox"/>	SMESB-01	Bidet toilet with slow closing seat and lid	25 9/16"	16 1/16"	18 13/16"	92.6

To Be Specified: Color

<input type="checkbox"/>	01 White	
--------------------------	----------	--

Compliance Certifications - Meets or Exceeds the Following Specification



Meets the Americans with Disabilities Act guidelines and ANSI A117.1 requirements for accessible and usable building facilities-check local codes when installed per accessibility guidelines of the act.

This toilet is designed to rough-in at a minimum dimension of (12") from finished wall to C/L of outlet. Supply not included with fixture and must be ordered separately.

Dimensions are nominal and are subject to change without prior notice. Dimension shown for location of supply is suggested. For additional information refer to installation instructions supplied.