

**WARRANTY**  
Limited Lifetime – Residential  
Limited 25-year – Commercial

**Manufactured from Swanstone solid surface**  
(see page 2 for detailed information)

*Recommended for high use traffic areas and commercial surfaces*

**FEATURES**

- Reinforced solid surface means color and texture run all the way through and cannot wear away
- Renewable surface will not wear away
- Coordinates with Swanstone shower and bath systems
- Chemical resistant—acetone will not harm
- Make-up and hair-dye can be buffed out with household cleansers
- Heat, stain and scratch resistant for lasting beauty
- Undermount style bowl installs into any countertop, including solid surface, tile and laminate

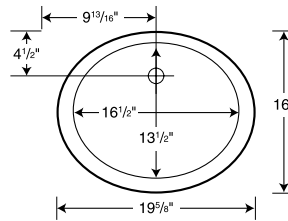

**UL-1613**  
Undermount

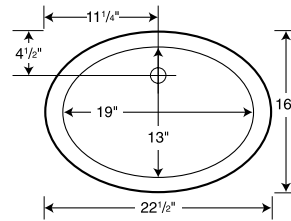

**UL-1913**  
Undermount

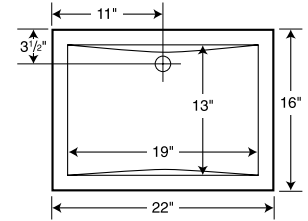

**UC-1913**  
Contour Undermount

**SPECIFICATIONS**

**Undermount Vanity Bowls**

Model	Part	Dimensions	Ship Wt. Lb.	Ship UPS	Carton Dims. In.	Cu. Ft.
UL-1613	UL01613	13-1/2" D x 16-1/2" W	8	UPS	26 x 22 x 9	2.98
UL-1913	UL01913	13" D x 19" W	15	UPS	25 x 21 x 8	2.43
UC-1913	UC01913	13" D x 19" W	14	UPS	25 x 21 x 8	2.43

Kit Includes: One compression molded vanity bowl plus complete installation instructions.

Packaging: Each Swanstone unit is packed in a rectangular carton.

**STANDARDS AND RATINGS**

- Class 1A fire rating
- American National Standard Institute—ANSI Z124.3
- International Association of Plumbing and Mechanical Officials (IAPMO)—listed cUPC listed—Certified to CSA Standard B45 by IAPMO
- National Sanitation Foundation-NSF Splash Zone, -NSF Food Zone
- American Society for Testing and Materials
- National Electrical Manufacturers Association

For a complete list of tests and results see the Technical Data Sheet – page 131.

**SUPPORT DOCUMENTS**

Installation instructions available on line at [www.swanstone.com](http://www.swanstone.com)

**MADE IN USA.**

**COLORS**

(See inside back cover for color sample.)

- White (010)
- Bone (037)
- Bisque (018)
- Almond Galaxy (046)
- Arctic Granite (035)
- Barley (091)
- Bermuda Sand (040)
- Gray Granite (042)
- Green Pasture (095)
- Sierra (094)
- Tahiti Blue (056)
- Tahiti Desert (050)
- Tahiti Evergreen (057)
- Tahiti Gray (053)
- Tahiti Ivory (059)
- Tahiti Matrix (058)
- Tahiti Rose (052)
- Tahiti Sand (051)
- Tahiti Terra (055)
- Tahiti White (011)
- Cornflower (063)
- Ironweed (061)
- Night Sky (012)
- Purple Sage (064)
- Wild Indigo (022)
- Winter Wheat (060)
- Indian Grass (071)
- Pebble (072)
- Seafoam (074)
- Glacier (121)
- Prairie (122)
- Acorn (123)
- Canyon (124)
- Cloud White (125)
- Cloud Bone (126)
- Baby's Breath (168)
- Caraway Seed (169)

**MAINTENANCE AND CLEANING INFORMATION**

Cleaning regularly with liquid cleansers such as Dow or Lysol foaming bubbles is recommended. If necessary, Ajax, Comet, Soft Scrub, Bon Ami, Barkeeper's Friend and similar abrasive cleaners are safe and effective for use with a Scotch-Brite, Mr. Clean Magic Eraser or other similar pads and sponges. Lime-Away, Rust Out, Whink or other similar mineral-stain removers are acceptable as well. **Do not** use SOS, Brillo or other metal scouring pads.