

Features:

- 26" (600) x 19" (482) x 11" (279) undermount kitchen sink.
- Single compartment.
- Handcrafted from 14 gauge 304 stainless steel. Channel grooves in sink bottom direct water to drain. Premium brushed finish.
- Beveled ledge around the top inside edge of the sink. The ledge allows a cutting board, colander and other accessories to easily glide across the length of the sink.
- Exclusive SinkPocket™ in front is hidden from view and makes great storage for sponges, brushes and other kitchen tools used daily.
- Includes a stainless steel bottom sink grid and matching basket sink strainer.
- Tight 3/16" (5mm) radius corners.
- 7mm sound deadening pads.
- Fits 30" (762) base cabinet width.

Components

Product includes:

PUSB261911SB Bottom Sink Grid
Matching Basket Strainer
Cutout Template
Installation Hardware
Installation Instructions



Warranty

- Lifetime Limited Warranty

Specified Model

Model	PUSB261911SB
Overall Dimensions	L26" x W19" x D11" 600 x 482 x 279
Bowl Dimensions	L22" x W14.3" x D11" 558 x 363 x 279
Drain hole:	3 5/8" (92mm)
Shipping Weight	37 lbs.
Material	14 gauge 304 stainless steel
Installation	under counter mounted
Required	template, included

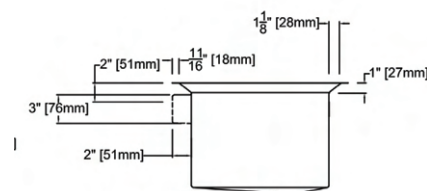
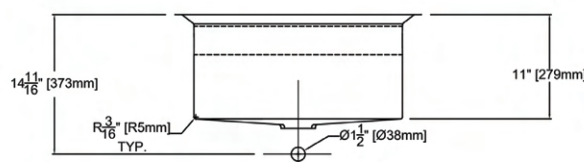
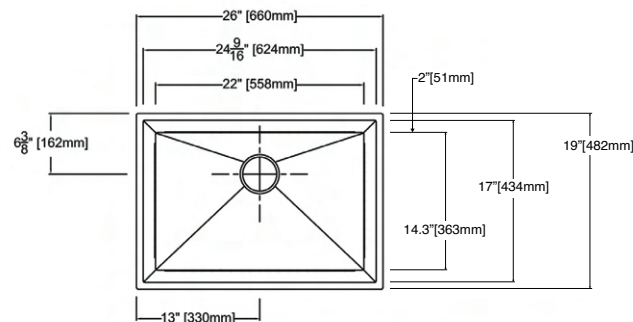

To Be Specified

	Color/Finish	Swatch
<input type="checkbox"/>	SB Satin Brass	
<input type="checkbox"/>	GM Gun Metal	

Codes/Standards

ASME A112.19.3/CSA B45.4

Notes

Install this product according to the installation instructions.

Components

Product includes:

PUSB15159SB Bottom Sink Grid

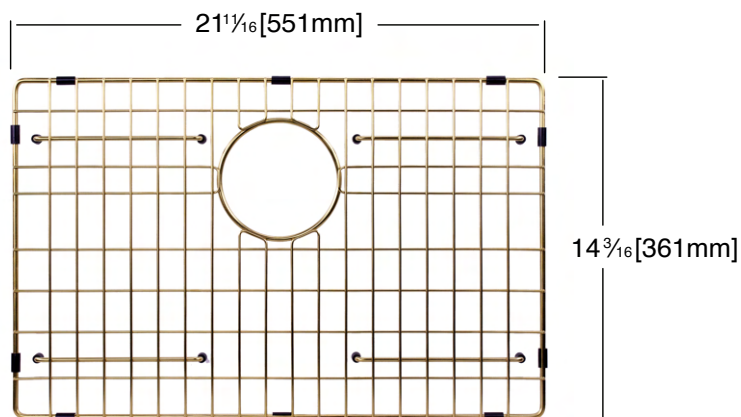

Matching Basket Sink Strainer



Satin Brass PVD finish strainer drains water easily and fits standard 3- $\frac{1}{2}$ " opening.