

USER MANUAL

- TE100
- TE400
- TR400

TABLE OF CONTENTS

Important Safeguards	2
Grounding Instructions	4
Name of Parts	5
Installation method	6
How to use	9
Maintenance	10
Troubleshooting	11
Specifications	13
Warranty	14

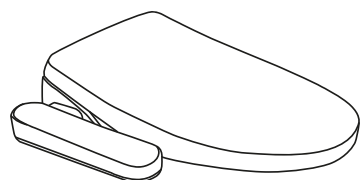

- This product was manufactured for household use only.
- Read all operating instructions before installation and use.
- Please save this operating instruction manual and place in an easily accessible location.
- External appearance and specifications are subject to change for improvement of product without notice.

Important Safeguards

READ ALL INSTRUCTIONS BEFORE USING.

DANGER To reduce the risk of electrocution.

Do not use while bathing.
Do not place or store product where it can fall or be pulled into a tub or sink.
Do not place in or drop into water or other liquid.
Do not reach for a product that has fallen into water. Unplug immediately.

WARNING To reduce the risk of burns, electrocution, fire or injury to persons.

- If the supply cord is damaged, it must be replaced by the manufacturer, its service agent or similarly qualified persons in order to avoid a hazard.
- Connect this product to a properly grounded outlet only.
- Unplug the appliance during filling and cleaning.
- Do not touch the power plug with wet hands.
- Properly connect the power cord to the electrical outlet corresponding to the rated voltage of the unit.
- Keep the cord away from heated surfaces.
- Do not use damaged or loose power cord.
- Before removing the unit from the toilet bowl, disconnect the power plug first.
- Do not connect other electrical appliances to the same power socket connected to the unit.
- Children should be supervised to ensure that they do not play with the appliance.
- This appliance is not intended for use by persons (including children) with reduced physical, sensory or mental capabilities, or lack of experience and knowledge, unless they have been given supervision or instruction concerning use of the appliance by a person responsible for their safety.
- Never operate this product if it has a damaged cord or plug, if it is not working properly, if it has been dropped or damaged, or dropped into water.
Return the product to a service center for examination and repair.
- Never block the air openings of the product or place it on a soft surface, such as a bed or couch, where the air openings may be blocked.
- Keep the air openings free of lint, hair, and the like.
Any other servicing should be performed by an authorized service representative.
- Close supervision is necessary when this product is used by, on, or near children or invalids.
- Do not dismantle, repair, or alter the unit.

2

Important Safeguards

WARNING To reduce the risk of burns, electrocution, fire or injury to persons.

- Never use while sleeping or drowsy.
- Never drop or insert any object into any opening or hose.
- Do not use outdoors, or operate where aerosol(spray) products are being used or where oxygen is being administered.
- Do not pour or spray water on to the unit.
- Do not use steam cleaner.
- Keep the unit away from fires or inflammable substance.
- Do not connect to the industrial water supplies.
- Caution against low temperature burns.
- New hose-sets supplied with the appliance are to be used and that old hose-sets should not be reused.

CAUTION To reduce the risk of injury to persons or damage to the product or the property.

- Do not place heavy objects or step on the unit.
It may cause product damage or injury.
- When cleaning the unit, do not use any chemicals. Clean the unit with moist, well-wrung soft cloth. For excessive stains, use soft cloth moistened with mild dish-wash detergent and wipe out with dry cloth.
It may cause product damage.
- Do not slam down the lid.
It may cause product defect.
- Do not lean against the lid.
It may cause product defect.
- When not in use for a long period of time, disconnect the power plug and drain the water tank.
Tank water may be contaminated and cause skin troubles.
- Do not twist or pull the connection hoses.
It may affect water supply or cause water leakage.
- Do not cover up the warm air outlet or insert hands or other objects.
It may cause burn or electric shock.
- Do not operate the unit during product malfunction.
Disconnect the power plug and call the authorized service center.
It may cause fire or electric shock if the unit is operated while it is out of order.

3

Grounding Instructions

WARNING Improper use of the grounding plug can result in risk of electric shock.

This product is for use a nominal 120v circuit and a GFCI (ground fault circuit interrupter) receptacle is required for use with this product. Do not use this product with an ungrounded outlet. Do not use an extension cord with this product.

If you do not have a GFCI receptacle, contact a qualified electrician to have installed.

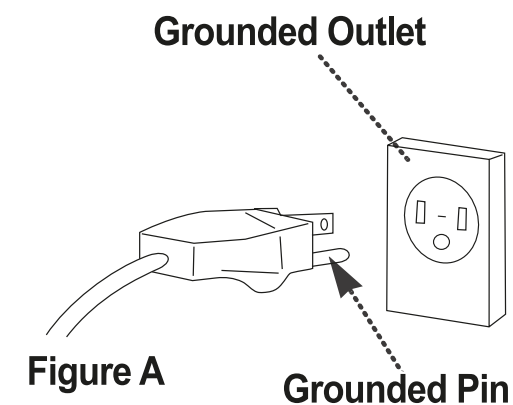

4

Name of parts

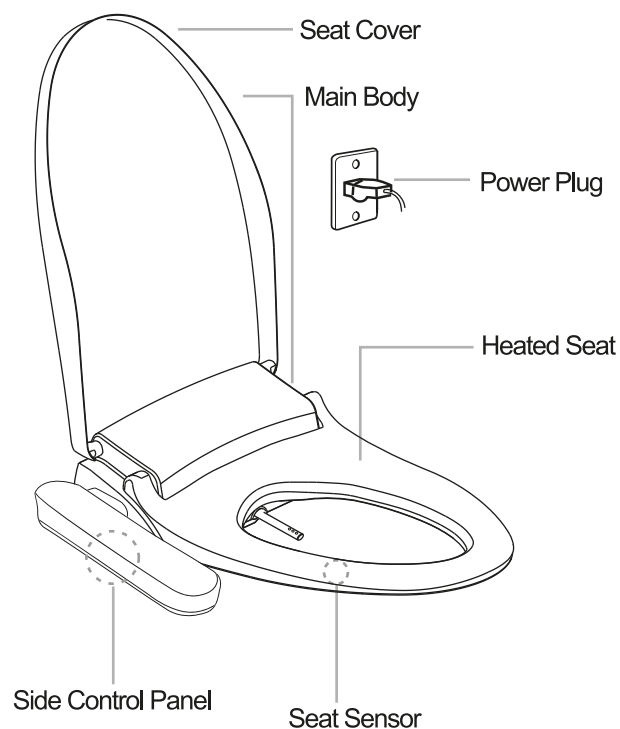

5

Installation method

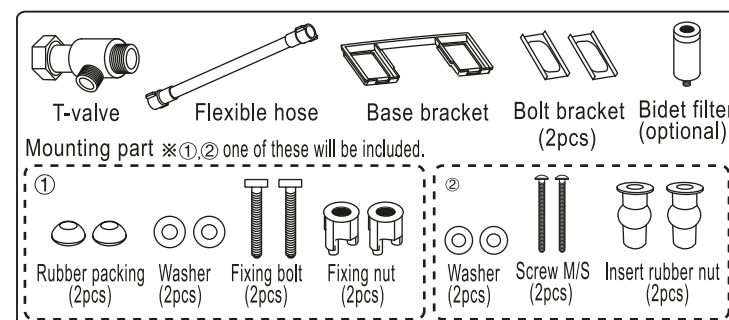

Before installation

- Read the instructions carefully before installing.
- Plug in only after complete installation then supply water

Installation procedure

1 Separate water supply hose

- Turn the water supply valve clockwise to lock, and separate the toilet hose using a spanner.

2 Remove the existing toilet seat

- Unfasten the nut and remove the toilet seat.
- Save the old toilet lid and nuts for reinstallation later.

6

3 Connect T-valve

- Install T-valve as shown

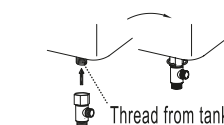

5 Insert the bidet body

- Mount the main bidet into the fixing holes.
- Align the front of the bidet body and the front of the toilet before fastening the nuts.

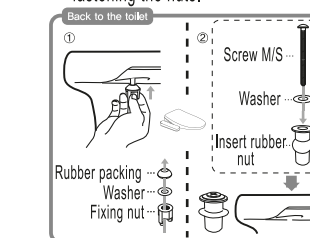

- Insert the main bidet into the groove on the installed base bracket.

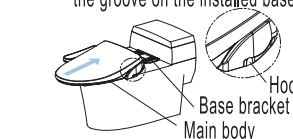

Operation check

1. Turn the water supply valve counterclockwise to check for water leakage.
2. Connect the power plug into electrical outlet.
3. Check the function for each type of use.

7

4 Insert the base bracket

- Align the base bracket groove with the toilet seat hole.
- Insert the fixing bolt into the base bracket and toilet seat hole.

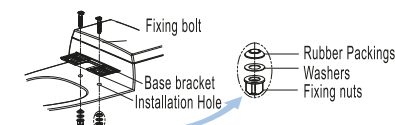

6 Connect the flexible hose

- Connect the flexible hose to the T-valve and the main body.
- Turn the water supply valve counterclockwise to allow water flow.

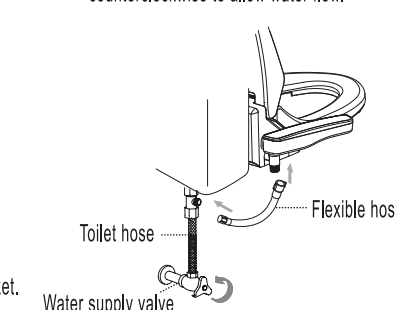

Memo

8

How to use (TE400, TR400)

STOP/FLUSH

- Press Stop button when you want to stop the function.
- When you press Flush button, Flushing works.

Posterior / Move

- Press Posterior/Move button, Wash function works.
- Press the button again during using this function.Move (Oscillation)function works
- Press the Move again, then Move function stops.

Feminine / Move

- Press Feminine/Move button, Feminine function works.
- Press the button again during using this function, Move (Oscillating) function works.
- Press the Move again,then Move function stops.

Exclusive

- Press Exclusive button, Enema wash works.
- It starts from the highest water pressure.

Dry

Use this after using wash function.

- Sweep the water with toilet paper before using dry function for pleasant using
- The Dry function stops in 3minutes.

Massage

- Press the Massage button during Posterior/Feminine function,water pressure pulsate from strong to soft.
- Press the button again,then Massage function stops.

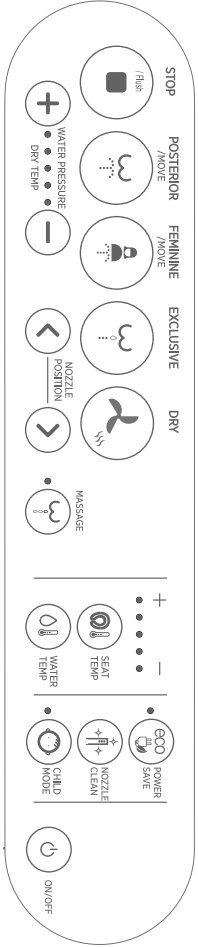

9

How to use (TE100)

STOP/FLUSH

- Press Stop button when you want to stop the function.
- When you press Flush button, Flushing works.

Posterior / Move

- Press Posterior/Move button, Wash function works.
- Press the button again during using this function.Move (Oscillation)function works
- Press the Move again, then Move function stops.

Feminine / Move

- Press Feminine/Move button, Feminine function works.
- Press the button again during using this function, Move (Oscillating) function works.
- Press the Move again,then Move function stops.

Exclusive

- Press Exclusive button, Enema wash works.
- It starts from the highest water pressure.

Massage

- Press the Massage button during Posterior/Feminine function,water pressure pulsate from strong to soft.
- Press the button again,then Massage function stops.

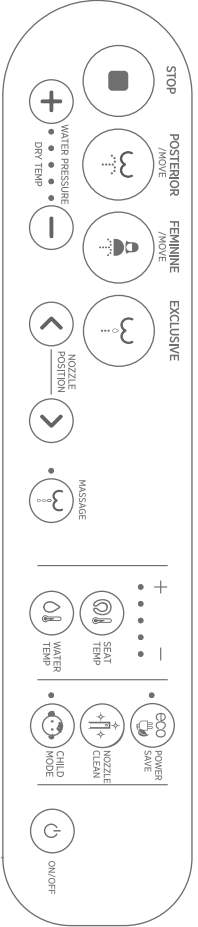

13

Maintenance

Use Power save

- Press the Power save button to save energy while no use.
- Press the button once(general saving mode),then LED(green light)turns ON, maintains the preset temperature for 30minutes after stand up,after that maintains water heater OFF, seat temperature at 30°C. (water heater & seat heater OFF in 24hours)
- Press the button twice(strong saving mode),then LED(red light) turns ON,water heater & seat heater OFF.
- To stop Power save funtion, press the button to turn LED off.
- In case user sit down while Power save mode, then seat sensor turns ON, water heater and seat heater start working automatically up to the preset temperature. (It takes 5minutes to get to the preset temperature)
- When user stand up, the seat sensor turns OFF, water heater and seat heater automatically return to Power save mode.
- Washing or Dry function can work under Power save mode.

Clean the Nozzle

- Use soft cloth or toothbrush to clean the nozzle.
- Do not use Abrasive, Volatile detergent, Acid/Alkaline detergent. It may cause breakage or trouble.

Nozzle clean (Automatic)

Press the Nozzle clean button under seat not occupied, then the nozzle extend out for self-cleaning for 2minutes.

Nozzle clean (Manual)

- Press the Nozzle clean button for 3seconds.
- Nozzle extends out for 2minutes.
- Clean the nozzle using toothbrush.
- Wipe the nozzle ambient with soft cloth or brush.

- ※ Do not pull out or push the nozzle forcibly.
- ※ Nozzle clean function does not work when seat occupied.
- ※ Nozzle clean function does not work in Child mode.



10

Specifications

Item		Description		
Model		TE400	TR400	TE100
Power rating		AC120V 60Hz 864W		
Ambient temperature		0~40 °C		
Water supply		Direct water connection		
Water pressure		98~735Kpa		
Wash	Posterior wash	Max 0.7 L/Min		
	Feminine wash	Max 0.8 L/Min		
	Exclusive wash	Max 0.75L/Min		
	Heater capacity	800W		
	Tank capacity	0.6L		
	Water temperature	Room temp - 40°C		
Dryer	Safety device	Thermal Fuse, Thermostat,Water Level Sensor		
	Heater capacity	250W		
	Air temperature	Room temp - 55°C		
Heated seat	Safety device	Thermal Fuse, Thermostat		
	Heater capacity	55W		
	Seat temperature	Room temp - 40°C		
Power cord length	Safety device	Thermal Fuse		
Product dimension		462mm x 535mm x 140mm (ALB-3600/3650/3670)		
		462mm x 495mm x 138mm (ALB-3600R/3650R/3670R)		
Product weight		4.5kgs (ALB-3600/3650/3670)		
		4.3kgs (ALB-3600R/3650R/3670R)		
Deodorizer		-	O	O
Auto flush		-	-	O

800 Bronze Rd. Warren, OH 44482

Troubleshooting

When you think the product is out of order, refer to the following for immediate measures.

Power supply

Trouble	Possible Causes	Solution
The unit is not working	Isn't the power out or isn't the circuit breaket off?	Wait until the power is restored. Or turn on the circuit breaker.
	Isn't the operation lamp on the display panel of the main body off?	Plug the power plug in the outlet.

Posterior wash, Feminine wash, Exclusive wash function

Trouble	Possible Causes	Solution
Water pessure is weak	Isn't the water pressure set to low level?	Adjust the water pressure to higher level.
	Isn't the strainer clogged?	Clean the strainer.
Water is cold	Isn't the temperature set to a low level? Or is it turned off?	Adjust the water temp on the control panel.
	Isn't it in power save mode?	The water temperture is set lower. Press the Power save again.
Water spray stops during use.	The washing stops 90seconds after pressing the Posterior,Feminine and Exclusive button.	Press the Posterior,Feminine and Exclusive button one more.
	Seat sensor may not touch human body.	Check the position of seat sensor on page 5.

11

Warranty

Product Warranty Card

- We warrant our products to be free from manufacturing defects under normal use and service for a period of one(1) year after purchase. This warranty is extended only to the original purchaser.
- For product defect, please contact your vendor or our service center.

Product Name	Model Name	
Date of Purchase	Serial Number	
Name of Purchase	Duration of Warranty	One year after purchase

< Free After-sales Service Regulations >

- During the duration of the warranty period, if product defect occurs during normal application as stated in the Instruction Manual, Cautionary Notes, Direction Labels, etc., the product is applicable for after-sales service free of charge.
- Even during the warranty period, after-sales service is not applicable free of charge in case of the following conditions :
 - (1) Damage occurring from customer negligence or fault, and defect or damage occurring from wrongful repair or alteration.
 - (2) Defect or damage occurring from fire, gas, flood, earthquake, lightning, other natural calamities, pollution, or abnormal electrical power.
 - (3) Defect or damage occurring from outside of normal household usage. (long term public usage, used inside a vehicle, installed inside a vessel, etc.)
 - (4) Defect or damage occurring from transportation of mistreatment after purchase.
 - (5) Defect or damage occurring during removal after installation.
 - (6) Wearing of consuming parts.(Packing, Filters, etc.)
 - (7) Product reinstallation by customer request.
 - (8) Read the Instruction Manual carefully before requesting for an after-sales services since charges will be invoiced for faulty service call visits.

Heated seat

Trouble	Possible Causes	Solution
The seat dose not warm up.	Isn't the temperature of seat set to OFF or low level?	Control the seat temperature on control panel.
	Isn't the bidet in power save mode?	The seat temperature is set lower Press the Power save again.

Seat sensor

Trouble	Possible Causes	Solution
The posterior wash or deodorant function works without sitting on the seat.	Isn't the seat wet or occupied by wet towel?	Wipe water out. Remove the wet towel.

Power Save

Trouble	Possible Causes	Solution
Power save is not working.	Isn't the unplugged? Or ist't the power out?	Reset the setting by pushing the power save button from the control panel

Self diagnosis

Trouble	Indication (LED lamp on Temperature control)	Symptom
Water supply stop. or water level sensor faulty	3stage LED blinks	Water not spray, warm water not spray
Water temperature sensor disconnected	5stage LED blinks	Warm water not spray
Water temperature sensor short circuit	4stage LED blinks	All washing function not working
Seat temperature sensor disconnected	2stage LED blinks	Seat not heated
Seat temperature sensor short circuit	1stage LED blinks	Seat not heated

12

Memo