

### FEATURES

- 60" x 32" Tub Walls for existing construction.
- Thick 1/4" 100% Solid Surface material for superior strength, beauty and easy cleaning. Surface will not support bacteria growth.
- Walls can be attached to moisture-resistant wall board, or directly over tile with supplied adhesive. Walls are trimmable for custom fit.
- Integrated pieces fit together for an easy, clean installation. Lap joint connection between upper and lower back wall forms a watertight seal.
- Two wall shelves and soap ledge included for convenient storage
- Wall Kit includes two wrap around front edge trim pieces, front and side top bullnose trim pieces with coped, mitered inside corners and a bullnose trim piece for use over backwall lap joint, one 1-oz. tube mounting adhesive, four 11-oz. tubes 100% silicone adhesive and one roll mounting tape.
- 10 Year Limited Residential Warranty / 3 Year Commercial Warranty

### COLORS

- 3 Natural Selections® colors with a 12" x 24" subway tile pattern.
- 3 Natural Selections® and 3 Classic colors with plain pattern.

### OPTIONS

- Extension wall panels add up to 24" of height to extend shower walls to ceiling.
- 2 Wall Pockets: horizontal, vertical; Window Trim Kit available. See Accessories Specification sheet for details.



Shown with X6022 Extension Wall Kit

STUDIO

### Specified Model

	SIZE	MODEL NO.	DESCRIPTION	Width	Depth	Height
<b>TUB WALLS KIT</b>						
<input type="checkbox"/>	60" x 32"	RBE6026	Wall Kit	60"	to 32"	60"
<b>OPTIONAL COMPONENTS</b>						
<input type="checkbox"/>	60" x 32"	X6022	Extension Panel Kit	60"	to 32"	24"
<b>COMPLETE TUB WALL KITS</b>						
<input type="checkbox"/>	60" x 32"	RKWX6026	Walls & Extension Kit	60"	to 32"	84"

### To Be Specified: Pattern/Color

#### 12 x 24" Subway Tile Pattern / Colors

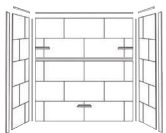

<input type="checkbox"/>	<b>91S</b> White Carrara
<input type="checkbox"/>	<b>94S</b> Sand Mountain
<input type="checkbox"/>	<b>96S</b> Almond Sky

#### Plain / Colors

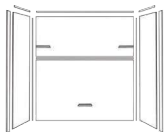

<input type="checkbox"/>	<b>01</b> White
<input type="checkbox"/>	<b>08</b> Biscuit
<input type="checkbox"/>	<b>67</b> Matrix Khaki
<input type="checkbox"/>	<b>86</b> Sea Shore
<input type="checkbox"/>	<b>91N</b> White Carrara
<input type="checkbox"/>	<b>94N</b> Sand Mountain
<input type="checkbox"/>	<b>96N</b> Almond Sky

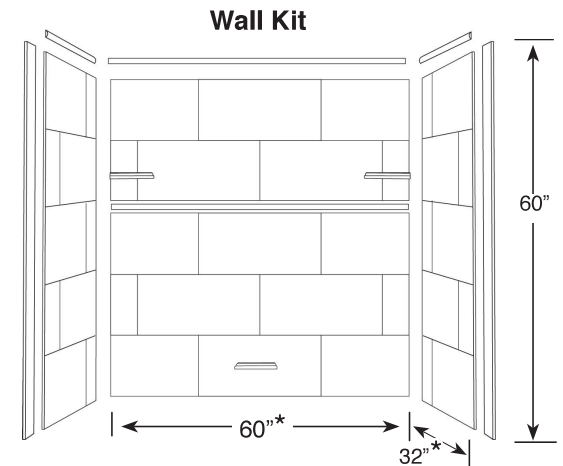
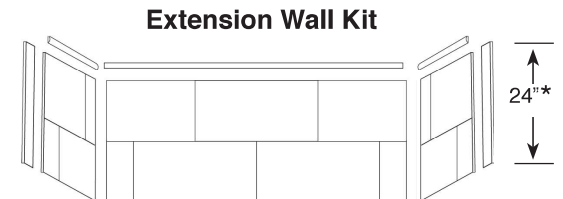

\* Can be trimmed to fit

# 60" x 32" tub walls

## RBE 6026

### INSTALLATION NOTES:

This product is to be installed according to the installation guide supplied with shower walls. This product designed to be installed over clean, smooth tile, waterproof drywall or cement board. If installing directly over tile, remove all loose pieces and fill for a consistent, smooth substrate.

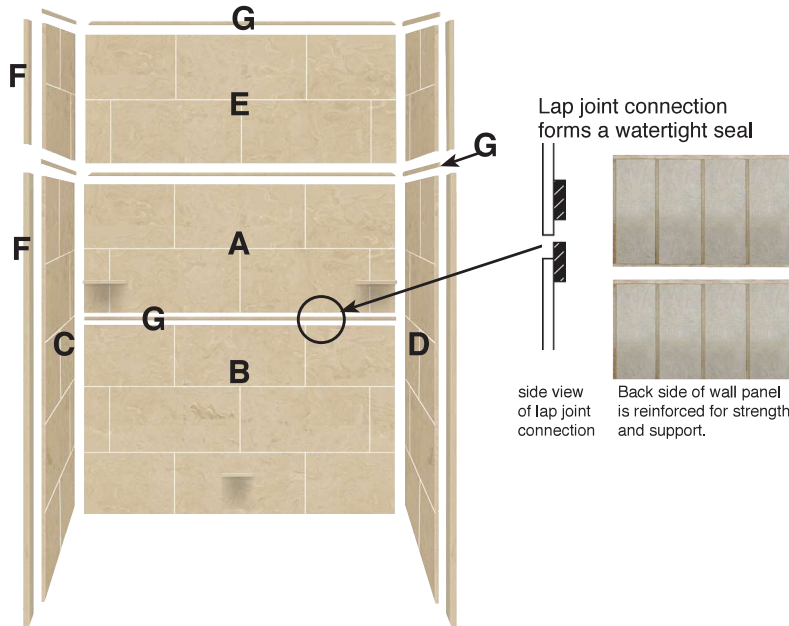

### F. Outside Edge Trim



Outside Edge Trim wraps around shower wall for finished look

### G. Bullnose Trim

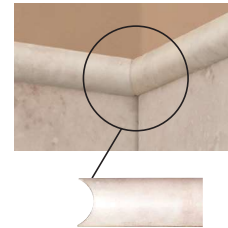

The solid surface bullnose molding used along the top edge of the walls and at backwall lap joint is contoured for easy fitting.

	MODEL #	DESCRIPTION
A	RB606U	Upper Back Wall (1 panel)
B	RB606D	Lower Back Wall (1 panel)
C	RE326L	Left End Wall (1 panel)
D	RE326R	Right End Wall (1 panel)
E	X6022	Extension Wall Kit

### OPTIONS: ACCESSORIES

Available for on-site installation. Must be ordered separately. See Accessories Specification for further information.

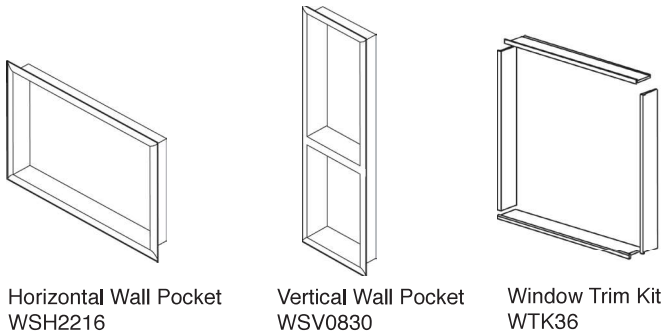

### Product Information

MODEL NO.	SHOWER DOOR	
	MAXIMUM WIDTH	MAXIMUM HEIGHT
RBE6026	57-1/2"	60"