

Thank you for purchasing Shower Niche. Please read the instructions carefully prior to installing the niche. These are basic instructions for the installation of a shower niche in a step-by-step sequence that will work in most types of installations. If you have an installation that is not covered in this manual, please contact the company directly for additional information to cover your application.

# 1. Product Specifications

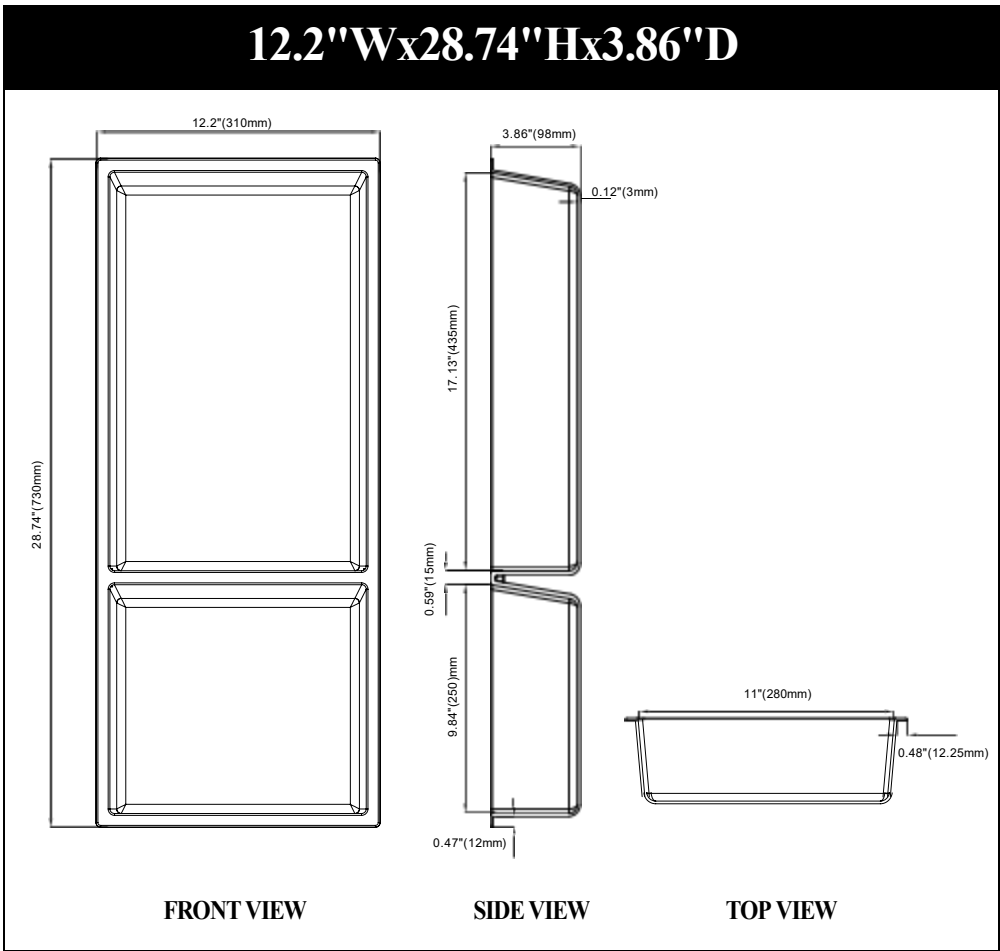

# 12.2"Wx39.37"Hx3.86"D

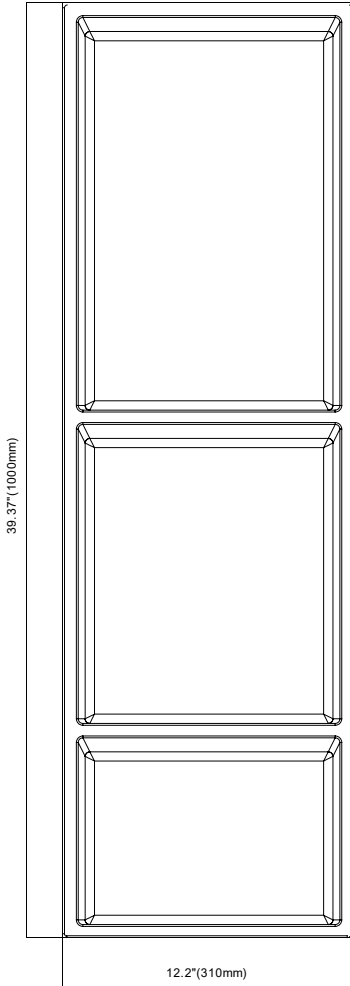

**FRONT VIEW**

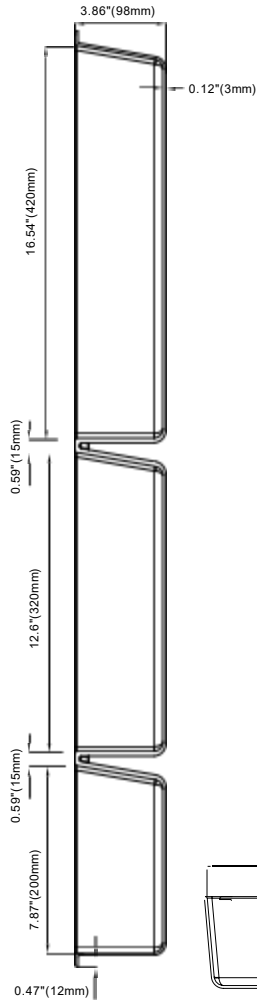

**SIDE VIEW**

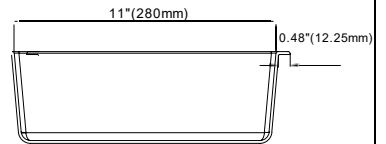

**TOP VIEW**

# 15.75"Wx96"Hx3.86"D

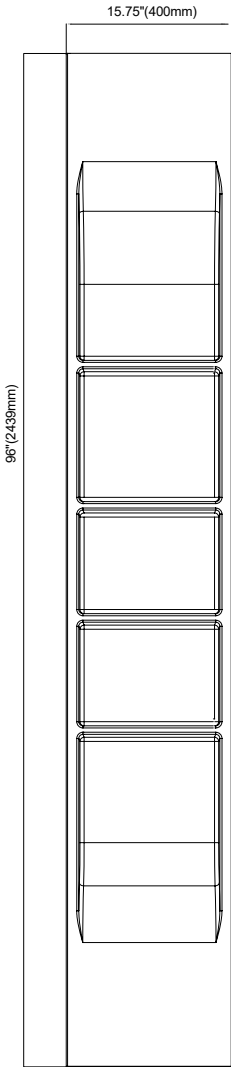

**FRONT VIEW**

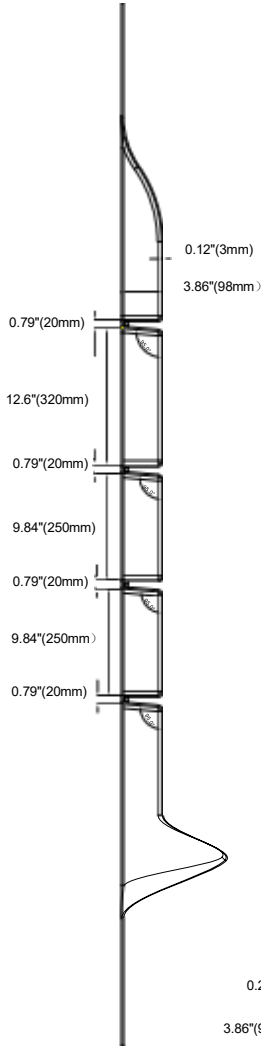

**SIDE VIEW**

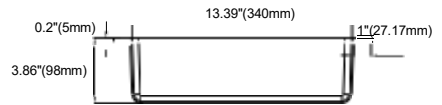

**TOP VIEW**

## 2. Preparation

To ensure proper installation, read all instructions thoroughly before starting. Prior to installation, examine all boxes and packages for shipping damage and compare the piece count with your packing slip. Unpack all shower niche(s) and inspect for damage. Verify the niches are the correct size and color for the intended application.

If the unit has been damaged, has a finishing defect, is the wrong item, or has missing parts, please contact our customer support department within 3 business days of the delivery date. Please note that we will not replace any damaged products or missing parts free of charge after 3 business days or if the product has been installed.

Note: Installation of a damaged product will void the warranty.

Please contact the company with any questions and please provide an order number, job name or other proof of purchase to help identify the original order.

The mounting surface must be free of dirt, film, waxes, or any other residues.

When installing the recessed niche, make sure to position the niche between the wall studs.

### 3. Installation

**Step 1:** Measure the exact height and width dimensions of the niche body (rear housing of the niche that sits recessed into the wall) of your niche model. Then, add 3mm to the height and to the width; this will allow a gap for installation and room for the niche flange to adhere to the shower wall around the wall cavity.

**Step 2:** Dry-fit the niche into the cut out area to ensure proper fit.

**Step 3:** Before starting the final installation, make sure the wall surface and the niche flange are clean and dry. Apply adhesive to the back of the niche flange.



**Step 4:** Insert the niche into the opening until the flange sits flat against the wall. Make sure the niche is straight and level. Wipe off any adhesive that squeezes out around the niche.



**Step 5:** Apply a filler all around to fill any gaps.

**Step 6:** Secure the niche in place with tape and leave alone for 24 hours to allow the filler and adhesive to cure.

## 4. Aftercare and Cleaning

**WARNING:** Cleaning products with labels that say, “not suitable for use with acrylic” SHOULD NOT BE USED. Read all labels carefully.

- Excessively hot water may cause surface damage.
- HARSH CHEMICALS SHOULD NEVER BE USED ON THE SHOWER NICHE SURFACE. Clean after use with a mild liquid household detergent cleaner. Do not use Lestoil, Lysol Disinfectant (spray or concentrate), or Lysol Basin, Tub and Tile Cleaner, Windex, Mr. Clean, Dow Disinfectant Bathroom Cleaner, or cleaning products in aerosol cans.
- Do not use wire brushes, knives or sharp objects to remove stains, cigarette tar deposits, or other surface blemishes.
- Abrasive cleaners or powders must not be used, since they will dull the surface. If the glossy surface loses its sheen, dulled areas or light scratches can be restored by rubbing with a white "automotive type" polishing compound and waxing with liquid wax.
- Do not allow nail polish remover, acetone, dry cleaning fluid, paint, paint remover, or other solvents to come into contact with the surface.
- Clean the surrounding surface immediately after using caustic drain cleaners.
- Burning cigarettes will damage the surface.