

Features

- 23" (584) x 18" (457) x 10" (254) undermount kitchen sink.
- Single compartment.
- Handcrafted from 16 gauge 304 stainless steel. Channel grooves in sink bottom direct water to drain. Premium brushed finish.
- Includes a stainless steel bottom sink grid and stainless covered flip-top sink strainer.
- 10mm radius corners.
- 5mm sound deadening pads.
- Fits 30" (762) base cabinet width.

Components

- Product includes:
- TSG23181 Bottom Sink Grid
 - 2210R Covered Sink Strainer
 - Cutout Template
 - Installation Hardware
 - Installation Instructions

Warranty

- Lifetime Limited Warranty



Specified Model

| Model | DUSB231810 |
|--------------------|---|
| Overall Dimensions | L23" x W18" x D10" 584 x 457 x 254 |
| Bowl Dimensions | L21 ³ / ₁₆ " x W16 ³ / ₁₆ " x D10" 539 x 412 x 254 |
| Drain hole: | 3 ⁵ / ₈ " (92mm) |
| Shipping Weight | 38 lbs. |
| Material | 16 gauge 304 stainless steel |
| Installation | under counter mounted |
| Required | template, included |

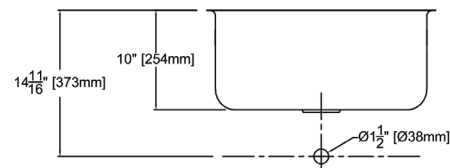
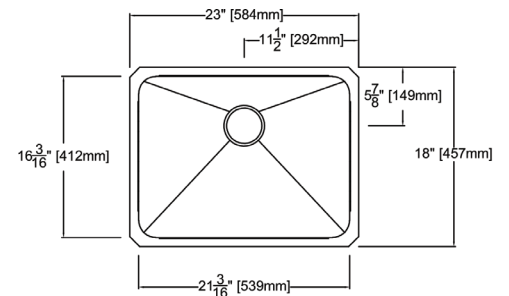

Codes/Standards

ASME A112.19.3/CSA B45.4

Notes

Install this product according to the installation instructions.

Components

Product includes:

TSG23181 Bottom Sink Grid

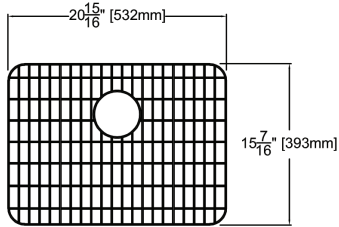

2210R Covered Flip Top Sink Strainer.

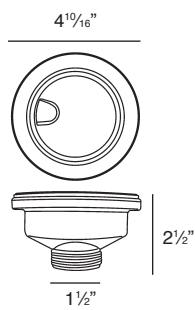

Water drains easily when cover is in place. Cover flips up with easy touch. Polypropylene housing. Fits standard 3 1/2" opening.

Optional 2310 Remote Covered Flip Top Sink Strainer is available.

Optional 4010 Covered Flip Top Disposer Strainer is available.

See Accessories to order.